

VIDVIE PRODUCT CATALOG

VIDVIE

<https://vidvietech.com/>

Foshan
Office: D1-03, Building D, Nanhai New Economic Industry Center,
No. 1 Xianan Road, Guicheng Street, Nanhai District, Foshan City, Guangdong

Shop NO.1 : No. 127, the 1st floor, Guangzhou the thirteen-hongs Culture and Technology Center, Exhibition
Building on the right side of New Asia, No. 37 Xidi Erma Road, Liwan District, Guangzhou

Shenzhen
RmY2-5F-03, No.5 Creative Zone, Yayuan Road, Bantian Street, Longgang District, Shenzhen, China

Shop NO.2 : A46-47, 1/F, Yale Smart Wearable International Market, Block D, Electronic & Technology Building,
Huaqiang North, Shenzhen

Contact Us:

✉ business@vidvietech.com

☎ +86 18565066884

🌐 Rain-VIDVIE

Super Design. Top Life >>>

STORAGE AND LIFE





FN02

Material: ABS+PP+POM+Hardware + Silicone
 Input voltage/current: DC5V/800mA
 Battery type: Ion battery (18650)
 Charging time: about 2h Gears: 2 gears
 Product weight: 125g Rated power: 2.5W
 Battery capacity: 1200mAh Working time: 2 files: about 2h
 1st gear about 5h Charging input port: Micro USB
 Product size: 58*60*192mm
 Weight: 116g

 Natural Wind
  Two Speeds
  Endurance
  Portable





SD2501

Interface: USB3.0
 Read and write speed: 120MB MAX
 Durability: Waterproof, cold-resistant, heat-resistant
 Capacity: 2g/4g-8g/16g/32g/64g/128g
 Operating temperature: 0°C~45°C
 Storage temperature: -10°C~75°C
 Color: Black orange

 3.0
USB3.0
  Safe and stable
  Wide compatibility





SD2601

Interface: USB3.0
 Read and write speed: 150MB/second
 Compatibility: USB3.0
 Capacity: 8g/16g/32g/64g
 Operating temperature: 0°C~45°C
 Storage temperature: -10°C~75°C
 Color: Black orange

 3.0
USB3.0
  Safe and stable
  Wide compatibility





New

WB01

Material: ABS+TPU
 Product size: 120*230*11.5mm
 Weight: 58.9g

 Underwater photography and video recording
  IPX8 Rated Waterproof
  30M waterproof depth
  Adjustable lanyard





KB01

Wireless Version: V5.1
Material: Leather + Microfiber
Battery capacity: 500mAh
Working Voltage: 3.2~4.2V
Using Distance: 10m
Applicable size: 10.9&11 inches/12.9 inches
Color: White/Black



KB04

Material: ABS+PC/Microfiber/Hardware
Battery capacity: 500mAh Charging current: 420mA
Using Distance: 10m Charging interface: Type-C
Charging time: 1-2h Battery life with light on: 12h
Battery life with light off: 100h
Standby time: >100 days
Keyboard life: >3 million times Size: 252*195*16.4mm
Weight: 630g Color: White/Black

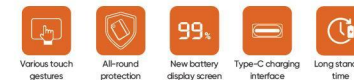

KB02

Wireless Version: V5.1
Battery capacity: 500mAh
Working Voltage: 3.2~4.2V
Using Distance: 10m
Applicable size: 10.9&11 inches/12.9 inches
Color: Black



KB05

Material: ABS+PC/Microfiber/Hardware
Battery capacity: 420mAh Charging current: 200mA
Using Distance: 10m Charging interface: Type-C
Charging time: 2.5h Battery life with light on: 5h
Battery life with light off: 30 days
Battery life with lights on: 5h
Standby time: about 60 days
Keyboard life: 3 million times Size: 245*150*7.7mm
Weight: 220g Color: White/Black/Blue



KB03

Wireless version: V5.1 Battery capacity: 140mAh
Material: aluminum alloy+ABS+silicone Number of keys: 64 keys
Sleep time: 10 minutes without operation
Charging interface: Type-C Standby time: 90 days
Working hours: 45h Compatible system: Windows, iOS, Android
Expanded size: 304.31*98.12mm Folded size: 152*98.12mm
Weight: 216g



KB06

Material: ABS+PC/Microfiber/Hardware
Battery capacity: 500mAh Charging current: 200mA
Using Distance: 10m Charging interface: Type-C
Charging time: 2.5h Battery life with light on: 5h
Battery life with light off: 30 days
Battery life with lights on: 5h
Standby time: about 60 days
Keyboard life: >3 million times Size: 245*175*7.7mm
Weight: 270g Color: White/Black/Blue





GM01



GM02

New



KB07

Battery capacity: 500mAh Working current: 30mA
Working mode: 2.4G+BT1+BT2
Working Scope: 3 position in optical technology
DPI: 800-1200-1600 Product material: ABS
Size: 113*57*25mm Weight: 69±5g
Color: Black

- Super long battery life
- Silent Design
- Type-C Charging Port



New



GM01

Material: ABS+aluminum alloy+magnet
Surface technology: electroplating
Interface: Type-C
Input voltage: 5V
Product size: 59.5*25mm
Weight: 62g



New



GM02

Material: PC+aluminum alloy
+tempered glass
Interface: Type-C
Input voltage: 5V/9V/12V
Wireless charging output:
15W/10W/7.5W/5W
Product size: 59.5*25mm
Weight: 62g



New



GM03

Product material: ABS+TPE
Microphone sensitivity: -42±3db
Frequency range: 20Hz-20khz
Product impedance: 16Ω
Speaker size: 10mm
Product interface: 3.5mm
Product line length: 120cm
Product weight: 21.2g
Product color: red
Working temperature: -20℃-60℃





SW1602

Wristband material: silicone
Wristband size: 260mm
Strap cover: Silicone
Suitable for wrist circumference: 150-205mm
Table tongue clasp: 304 stainless steel
Charging method: magnetic charging cable

5.0
Android

9.0
IOS

2.0
HarmonyOS



SW1606-Smart Watch Ultra

Main control chip CPU: Realtek RTL8762DT
Compatible systems: Android5.0 and above; iOS 9.0 and above
Shell Material: Zinc Alloy Wristband material: silicone strap
Flash memory: 128MB Waterproof grade: IP68 Charging time: about 3.5H
Battery life: 7-15 days Screen size: 1.96 inches Resolution: IPS 320*390
Wireless version: 5.0 Heart rate: HX3605 Touch type (Type): full touch screen Battery type: polymer lithium battery
Capacity: 3.7V/320mAh Charging method: wireless charging
Product size: 49*44*12mm Wristband size: total length 226.6mm, 21mm wide
Product weight: 72g Working temperature: 0-50 C

Phone Calls
Reminding

Heart Rate
Alarm Reminder

SMS
Notification

IP68
Waterproof

180 Kinds
Sport Mode

Scan code
to pay



SW1606-Wireless Charger

Input: 4.9v~5.5v=1A Max
Output: 2.5W Max

2.5w





SW1607

New



SW1609

Main control chip CPU: RTL8762DT
Compatible systems: Android5.0/iOS9.0+
Shell material: zinc alloy Wristband Material: silicone strap/steel strap/belt
RAM: 192KB ROM: 128M (External Flash) Waterproof grade: IP67
Charging time: 160min Battery life: 5-7 days
Screen size: 1.39 inches Resolution: IPS 360*360 Wireless version: 5.1
Touch type (Type): full touch screen Battery type: polymer lithium battery
Capacity: 3.7V/270mAh Charging method: wireless charging
Working temperature: 0-50°C

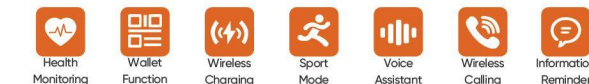

New



SW1610

Main control chip CPU: AC6954
Compatible systems: Android5.0/iOS9.0+
Shell material: zinc alloy Wristband Material: Silicone strap/strap
RAM: 192KB ROM: 16Mb (put code)+64Mb (for dial UI)
Waterproof grade: IP67
Charging time: 180min Battery life: 3-5 days
Screen size: 1.39 inches Resolution: IPS 240*240 Wireless version: 5.1
Touch type (Type): full touch screen Battery type: polymer lithium battery
Capacity: 3.7V/250mAh Charging method: wireless charging
Working temperature: 0-50°C



New



SW1611

Wireless version: 5.1 Main control chip CPU: AC6954
Compatible systems: Android 4.4+/iOS8.0+
Shell material: zinc alloy Wristband material: silicone strap
Memory RAM: 192KB ROM: 16Mb (for code) + 64Mb (for dial UI)
Waterproof grade: IP67 Charging time: 160min
Battery life: 3-5 days Screen size: 1.8 inches
Resolution: IPS 240*286 Touch type (Type): full touch screen
Battery type: polymer lithium battery Capacity: 3.7V/240mAh
Charging method: wireless charging Working temperature: 0-50°C

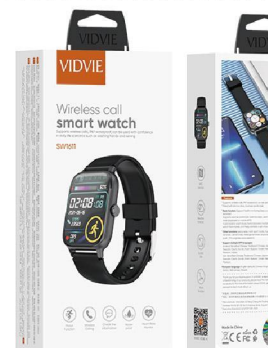

New

SW1612

Main control chip CPU: JL7012 Shell material: zinc alloy
Wristband material: silicone strap Memory RAM: 640+32KB
ROM: 128M (plug-in Flash) Waterproof level: daily waterproof
Charging time: 160min Battery life: 3 days
Screen size: 2.01 inches Resolution: IPS 240*296
Wireless version: BT3.0/Ble5.1 Touch type (Type): full touch screen
Battery type: polymer lithium battery Capacity: 3.7V/210mAh
Charging method: wireless charging Product weight: 40.01g (excluding case)
Working temperature: 0-50°C

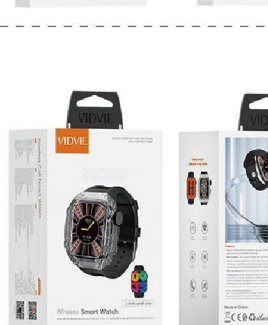

New

SW1613

Main control chip CPU: JL7012 Shell material: zinc alloy
Wristband material: silicone strap Memory RAM: 640+32KB
ROM: 128M (plug-in Flash storage dial UI)+128M (plug-in Flash to store music)
Waterproof grade: IP67 Battery life: 3-5 days
Screen size: 1.91 inches Resolution: IPS 240*296
Wireless version: BT3.0/Ble5.1 Touch type (Type): full touch screen
Battery type: polymer lithium battery Capacity: 3.7V/220mAh
Charging method: wireless charging Working temperature: 0-50°C
Product weight: 36.1g (excluding watch case)



New



SW1607

Main control chip CPU: RTL8763E
Compatible systems: Android5.0 above; iOS 9.0 or above, HarmonyOS 2.0
Shell material: zinc alloy Wristband Material: Silicone Strap
Flash memory: 128MB Waterproof grade: IP68
Charging time: 2-3H Battery life: about 4 days, about 7 days without calls
Screen size: 1.39 inches Resolution: 360*360 Wireless version: 5.2
Heart rate: dynamic heart rate Touch type (Type): full touch screen
Battery type: polymer lithium battery Capacity: 3.7V/300mAh
Charging method: Magnetic charging Product size: 49*52*12.3mm
Wristband size: total length 218mm, Width 22mm
Product weight: 69.4g Working temperature: 0-45°C



New



SW1608

Main control chip CPU: ZK8918C
Compatible systems: Android5.0 above; iOS 9.0 above
Shell material: zinc alloy Wristband Material: Silicone Strap
Flash memory: 32MB Waterproof grade: IP67
Charging time: about 3H Battery life: 7-15 days
Screen size: 1.85 inches Resolution: IPS 240*285 Wireless version: 5.0
Touch type (Type): full touch screen Battery type: polymer lithium battery
Capacity: 3.7V/200mAh Charging method: wireless charging
Product size: 44*38.3*11.35mm
Wristband size: total length 258mm, Width 21.5mm
Product weight: 48.3g Working temperature: 0-50°C





SW1615

SW1617



New



SW1611

Wireless version: 5.1 Main control chip CPU: AC6954
Compatible systems: Android 4.4+/IOS8.0+
Shell material: zinc alloy Wristband material: silicone strap
Memory RAM: 192KB ROM: 16Mb (for code) + 64Mb (for dial UI)
Waterproof grade: IP67 Charging time: 160min
Battery life: 3-5 days Screen size: 1.8 inches
Resolution: IPS 240*286 Touch type (Type): full touch screen
Battery type: polymer lithium battery Capacity: 3.7V/240mAh
Charging method: wireless charging Working temperature: 0-50°C



SW1612

Main control chip CPU: JL7012 Shell material: zinc alloy
Wristband material: silicone strap Memory RAM: 640+32KB
ROM: 128M (plug-in Flash) Waterproof level: daily waterproof
Charging time: 160min Battery life: 3 days
Screen size: 2.01 inches Resolution: IPS 240*296
Wireless version: BT3.0/Ble5.1 Touch type (Type): full touch screen
Battery type: polymer lithium battery Capacity: 3.7V/210mAh
Charging method: wireless charging Product weight: 40.01g (excluding case)
Working temperature: 0-50°C



SW1613

Main control chip CPU: JL7012 Shell material: zinc alloy
Wristband material: silicone strap Memory RAM: 640+32KB
ROM: 128M (plug-in Flash storage dial UI)+128M (plug-in Flash to store music)
Waterproof grade: IP67 Battery life: 3-5 days
Screen size: 1.91 inches Resolution: IPS 240*296
Wireless version: BT3.0/Ble5.1 Touch type (Type): full touch screen
Battery type: polymer lithium battery Capacity: 3.7V/220mAh
Charging method: wireless charging Working temperature: 0-50°C
Product weight: 36.1g (excluding watch case)



SW1614

Main control chip CPU: RTK8763EWE Shell material: ABS+zinc alloy
Wristband material: silicone strap Memory RAM: RAM640KB ROM128Mb
Waterproof grade: IP68 Battery life: 5-7 days
Screen size: 2.02 inches Resolution: 320*386
Wireless version: BT5.1 Touch type (Type): full touch screen
Battery type: polymer lithium battery Capacity: 400mAh
Charging method: magnetic suction Charging time: 2.5H
Product weight: 59.44g Working temperature: 0-50°C



SW1615

Main control chip CPU: JL7012 Shell material: zinc alloy
Wristband material: silicone strap Memory RAM: 128Mb
Waterproof grade: daily waterproof Battery life: 3-4 days
Screen size: 2.1 inches Resolution: IPS 330*390
Wireless version: BT 3.0/5.0 Touch type (Type): full touch screen
Battery type: polymer lithium battery Capacity: 3.7V/220mAh
Charging method: Wireless charging Charging time: 2-3H
Product weight: 57g Working temperature: 0-50°C



SW1617

Main control chip CPU: JL7012 Shell material: ABS+PC
Wristband material: silicone strap Memory RAM: Flash:128Mb
Waterproof grade: IP68 Battery life: 4-7 days
Screen size: 1.43 inches Resolution: 466*466
Wireless version: BT5.3 Touch type (Type): AMOLED
Battery type: polymer lithium battery Capacity: 300mAh
Charging method: magnetic suction Charging time: 2H
Product weight: 41.29g Working temperature: 0-50°C





WA01

- Size: 38/40/41mm
- * Material: High quality eco-friendly silicone;
 - * Multi-color matching, any versatile;
 - * Skin-friendly and soft, feel comfortable;
 - * For iwatch1/2/3/4/5/6/7/8/SE.
- Size: 42/44/45/49mm
- * Material: High quality eco-friendly silicone;
 - * Multi-color matching, any versatile;
 - * Skin-friendly and soft, feel comfortable;
 - * For iwatch1/2/3/4/5/6/7/8/SE/Ultra.
- Color: Midnight/white/yellow/black/
Midnight Blue/star Color/alfalfa/orange



WA05

- Size: 38/40/41mm
- * Material: high-quality environmentally friendly silicone + precision steel buckle
 - * Dimensions: 38/40/41mm
 - * Multi-color collocation, any match
 - * Skin-friendly and soft, comfortable to touch,
 - * For iwatch1/2/3/4/5/6/7/8/SE
- Size: 42/44/45/49mm
- * Material: high-quality environmentally friendly silicone + precision steel buckle
 - * Dimensions: 42/44/45/49mm
 - * Multi-color collocation, any match
 - * Skin-friendly and soft, comfortable to touch,
 - * For iwatch1/2/3/4/5/6/7/8/SE/Ultra
- Color: Blue/Gold/Black/Silver/Grey/Midnight blue



WA02

- Size: 38/40/41mm
- * Material: Nylon Braid
 - * Multi-color matching, any versatile 100% light, thin and flexible, the strap is strong and elastic, secure and convenient to wear.
 - * For iwatch1/2/3/4/5/6/7/8/SE
- Size: 42/44/45/49mm
- * Material: Nylon Braid
 - * Multi-color matching, any versatile 100% light, thin and flexible, the strap is strong and elastic, secure and convenient to wear.
 - * For iwatch1/2/3/4/5/6/7/8/SE/Ultra
- Color: Orange/star Color/green/black



WA03

- Size: 38/40/41mm
- * Material: Nylon Braid
 - * Multi-color matching, any versatile
 - * Double-layer nylon weave, high strength and wear resistance, soft and dense, convenient snap interface, more convenient installation and disassembly
 - * For iwatch1/2/3/4/5/6/7/8/SE
- Size: 42/44/45/49mm
- * Material: Nylon Braid
 - * Multi-color matching, any versatile
 - * Double-layer nylon weave, high strength and wear resistance, soft and dense, convenient snap interface, more convenient installation and disassembly
 - * For iwatch1/2/3/4/5/6/7/8/SE/Ultra
- Color: Yellow With Beige/blue With Grey/black With Grey



WA04

- Size: 38/40/41mm
- * Material: high-quality environmentally friendly silicone + precision steel buckle
 - * Dimensions: 38/40/41mm
 - * Multi-color collocation, any match
 - * Skin-friendly and soft, comfortable to touch,
 - * For iwatch1/2/3/4/5/6/7/8/SE
- Size: 42/44/45/49mm
- * Material: high-quality environmentally friendly silicone + precision steel buckle
 - * Dimensions: 42/44/45/49mm
 - * Multi-color collocation, any match
 - * Skin-friendly and soft, comfortable to touch,
 - * For iwatch1/2/3/4/5/6/7/8/SE/Ultra
- Color: Blue/Gold/Black/Silver/Grey/Midnight blue





WS01



AP01



WS01

Size: 49mm

- * Shell-film integrated protective case, suitable for Apple watch Ultra, comprehensive protection, scratch-resistant and non-slip, sensitive to touch;
- * Hollow-out design on the back, it can be charged without removing the protective case, which is practical and convenient;
- * High-definition and high-transparency, original picture quality;
- * Multi-color optional, match as you like.

Color: Transparent/Black/White/Silvery/Midnight Blue
Star Color/orange



WS02

Size: 41/45mm

- * Shell-film integrated protective case, suitable for Apple watch 7/8, full protection, anti-scratch and non-slip, sensitive to touch;
- * Hollow-out design on the back, it can be charged without removing the protective case, which is practical and convenient;
- * High-definition and high-transparency, original picture quality;
- * Multi-color optional, match as you like.

Color: Transparent/Black/White/Silvery/Midnight Blue
Translucent color



New



AP01

Pen body material/process: Aluminum Alloy/Baking Paint
battery capacity: Lithium battery 3.7V 90mAh
Charging voltage: DC 5V Charging current: 100mA
Use time: 7h Charging time: about 50 minutes
Diameter: 9mm Charging interface: no
Overall product length: 166.33 mm
Pen tip diameter: 1.5mm (original nib)
Smart power saving: 5 minutes idle sleep
Power display: wireless screen display Weight: 14.6g



New



AP02

Pen body material/process: Aluminum Alloy/Baking Paint
battery capacity: Lithium battery 3.7V 140mAh
Charging voltage: DC 5V
Charging current: 300mA Use time: 7h
Charging time: about 40 minutes Diameter: 9mm
Charging interface: Top Lightning charging port
Overall product length: 167.6 mm Pen tip diameter: 1.9mm
Smart power saving: 5 minutes idle sleep
Power display: wireless screen display Weight: 14.6g





AP04



AP06

New



AP03

Pen body material/process: Aluminum Alloy/Baking Paint
 battery capacity: Lithium battery 3.7V 140mAh
 Charging voltage: DC 5V Charging current: 300mA
 Use time: 7h Charging time: about 40 minutes
 Diameter: 9mm Charging interface: Top Type-C charging port
 Overall product length: 167.6 mm Pen tip diameter: 1.9mm
 Smart power saving: 5 minutes idle sleep
 Power display: wireless screen display Weight: 14.6g



New



AP05

Pen body material/process: Aluminum Alloy/Baking Paint
 Battery capacity: Lithium battery 3.7V 140mAh
 Charging voltage: DC 5V Charging current: 500mA
 Use time: 9h Charging time: about 40 minutes
 Diameter: 9mm Charging interface: Type-C
 Overall product length: 165.29 mm Pen tip diameter: 1.9mm
 Smart power saving: 120 minutes automatic power off
 Power display: indicator light Weight: 14.6g



New



AP04

Pen body material/process: Aluminum Alloy/Baking Paint
 Battery capacity: Lithium battery 3.7V 90mAh
 Charging voltage: DC 5V Charging current: 100mA
 Use time: 7h Charging time: about 50 minutes
 Diameter: 9mm
 Charging method: magnetic suction wireless charging
 Overall product length: 166.47mm Nib diameter: 1.5mm (original nib)
 Smart power saving: 10 minutes idle sleep
 Power display: digital display Weight: 12.8g



New



AP06

Pen body material/process: Aluminum Alloy/Baking Paint
 Battery capacity: Lithium battery 3.7V 140mAh
 Charging voltage: DC 5V Charging current: 450mA
 Use time: 10h Charging time: about 40 minutes
 Diameter: 9mm Charging interface: Type-C
 Overall product length: 164.4mm Nib diameter: 1.5mm
 Smart power saving: 10 minutes idle sleep
 Power display: indicator light Weight: 12.7g





HUB01-6 IN 1

Product material: aluminum alloy + ABS
Working voltage: 5-20V
Line length: 10cm
Input: Type-C
PD port: 20V/3A 60W (Max)
USB3.0: 5Gbps (Max)
USB2.0: 480Mbps (Max)
HDMI: 4K@30Hz(Max.)
RJ45: 100Mbps (Max.)
Product size: 100*48*15mm

480 Mbps
USB2.0
5 Gbps
USB3.0
4K @30Hz
HDMI
100 Mbps
RJ45



HUB03-6 IN 1

Product material: aluminum alloy + ABS
Working voltage: 5-20V
Line length: 10cm
Input: Type-C
PD port: 20V/5A 100W (Max)
USB3.0: 5Gbps (Max)
USB2.0: 480Mbps (Max)
HDMI: 4K@30Hz(Max.)
Product size: 255*31.4*9.9mm

480 Mbps
USB2.0
5 Gbps
USB3.0
4K @30Hz
HDMI
60 MB/s
SD/TF 2.0



HUB02-4 IN 1

Product material: aluminum alloy + ABS
Working voltage: 5-20V
Line length: 10cm
Input: Type-C
VGA: 1080P60Hz
PD port: 20V/5A 100W (Max)
USB3.0: 5Gbps (Max)
HDMI: 4K@30Hz(Max.)
Product size: 210*40.7*13.9mm

100W
PD Port
5 Gbps
USB3.0
4K @30Hz
HDMI
1080 P60Hz
VGA



HUB04-3 IN 1

Product material: aluminum alloy + ABS
Working voltage: 5-20V
Line length: 10cm
Input: Type-C
PD port: 20V/5A 100W (Max)
USB3.0: 5Gbps (Max)
HDMI: 4K@30Hz(Max.)
Product size: 67.8*30.5*9.1mm

5 Gbps
USB3.0
4K @30Hz
HDMI
100W
PD Power Port



AUTOMOBILE PRODUCTS



VC001



VC004



VC001

Suction: 5000pa
Power: 50W
Input voltage: DC-5V-2A
Battery capacity: 14.4Wh
Battery life: 16min Charging time: 3.5h
Product size: 60*235*60mm
Weight: 409g
Car, home, office, multi-application scenario use

-  Powerful vacuuming
-  Large capacity battery life
-  Not tiring to hold
-  One-click vacuuming



New



VC004

Material: ABS+aluminum alloy
Product size: 276*57mm Weight: 493.45g
Colour: Black Input: 5V/2A
Power: 85W Noise: ≤85dB
Battery capacity: 11.1V/2000mAh
Charging time: about 270min
Suction power: First gear 7000-8000Pa
Second gear 13000-14000Pa

-  Powerful vacuuming
-  Super long battery life
-  Storage and carrying
-  High-end LED large screen

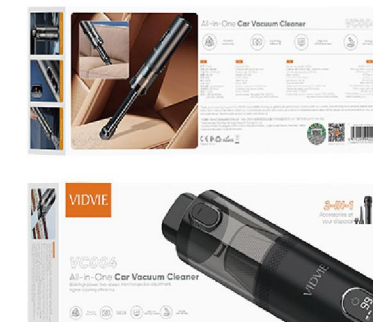



VC001



VC004



CSP001

Material: ABS
 Battery pack: polymer Wireless working voltage: 15V
 Maximum current of wireless working: 6A
 Maximum power of wireless working: 90W
 Battery capacity: 8000mAh
 Charging time: 4h
 Maximum pressure value: 150PSI

New



Car Vacuum



Start Power Supply



Air Pump



Blowing Machine



Power Bank Charging Function



PROJECTION PRODUCTS



TS001

Chip: HI352 Brightness ANSI: 240ANSI LED lamp power: 40W
 Resolution: 1280*720P Image size/distance: 100" @ 2.95m
 Supported screen ratio: 16:9/4:3 Dynamic contrast: 2000:1
 Stereo speaker power: 3W Power supply: AC 90-240V 50/60Hz
 Power: Normal 46W Standby <0.5W Product size: 124*124*220mm
 Product weight: 995±30g
 Working temperature: -10°C - 50°C



VIDVIE

<https://vidvietech.com/>

Foshan
Office: D1-03, Building D, Nanhai New Economic Industry Center,
No. 1 Xianan Road, Guicheng Street, Nanhai District, Foshan City, Guangdong

Shop NO.1 : No. 127, the 1st floor, Guangzhou the thirteen-hongs Culture and Technology Center, Exhibition
Building on the right side of New Asia, No. 37 Xidi Erma Road, Liwan District, Guangzhou

Shenzhen
RmY2-5F-03, No.5 Creative Zone, Yayuan Road, Bantian Street, Longgang District, Shenzhen, China

Shop NO.2 : A46-47, 1/F, Yale Smart Wearable International Market, Block D, Electronic & Technology Building,
Huaqiang North, Shenzhen

Contact Us:

✉ business@vidvietech.com

☎ +86 18565066884

☎ Rain-VIDVIE



VIDVIE® is a registered trademark, owned by Shenzhen Aifeng Chengpin Trading Co., Ltd. Shenzhen Aifeng Chengpin Trading Co., Ltd. has all the right to interpret matters related to this album.
The products displayed in the VIDVIE full-category product catalog are new products as of January 2021. New products on the shelves after January 2021 are not in this catalog. You can consult our sales staff for the latest product information.
If the products shown in this album are revised in the future, please refer to the information provided by the salesperson of our company. This album is for reference only.